



ultraframe

victoriansystem

Version: 1.0
Date: January 2003

installation guide

ultraframe
CONSERVAFLASH™
the pre-formed pvc flashing system



It is Ultraframe's policy to continually seek to improve its products, processes and services, and we reserve the right to change specifications without prior notice. Ultraframe is a trading name of Ultraframe (UK) Limited

FOR TRAINING AND QUALITY PURPOSES, SOME CALLS MAY BE MONITORED

ultraframe



Ultraframe (UK) Ltd
Salthill Road, Clitheroe,
Lancashire, BB7 1PE
Tel +44 (0) 1200 452288
Fax +44 (0) 1200 452258
techsupport@ultraframe.co.uk
www.ultraframe.com

world class conservatory systems

Duo-pitch Conservatories



Ensure the pre-formed soaker is clipped onto the rear of the wall starter bar prior to fixing the starter bar to the host wall.



With a 9" angle grinder, chase out the horizontal mortar joint (to suit the flashing length) on each course of brickwork to a depth of 35mm to allow the 30mm deep upper leg of Conservafash™ to sit flush to the brickwork face.



Trial fit the flashing (for depth) prior to applying the silicone.



Once trialed, remove. Start installing Conservafash™ from the gutter end towards the ridge. Apply silicone (clear or grey low modulus neutral cure) along the 2 internal weatherbar grooves.



Place Conservafash™ into the ground out mortar joint (at the gutter end) and slide into position ensuring lower edge locates into the 'J' soaker. The unique integral mechanical retention wedge clips "bite" into the brickwork ensuring positive location. Insert the next section ensuring you overlap the previous section (indicated by the minimum overlap). Again, apply silicone and continue up the roof.



Repeat the process on the opposite side. **AT THIS STAGE FIT THE EXTERNAL RIDGE CAPPING AND FLASHING TRIM.**



Place the ridge saddle apron around the ridge flashing trim and seal back to the host wall. Grind out the the course immediately above the apron, then insert the horizontal flashing (usually two course above the stepped flashings). Trim the edges to suit the roof pitch. Finally fully seal the ridge flashing and apron edges to the host wall.



Silicone seal the top edge of all the stepped flashings with clear or grey low modulus neutral cure silicone.



Continue to glaze the roof.

Lean-to Conservatories



With a 9" angle grinder, chase out the horizontal mortar joint (35mm deep) which best suits the drop of conservafash™ when positioned immediately above the upstand of the wallplate top capping (approx one course above).

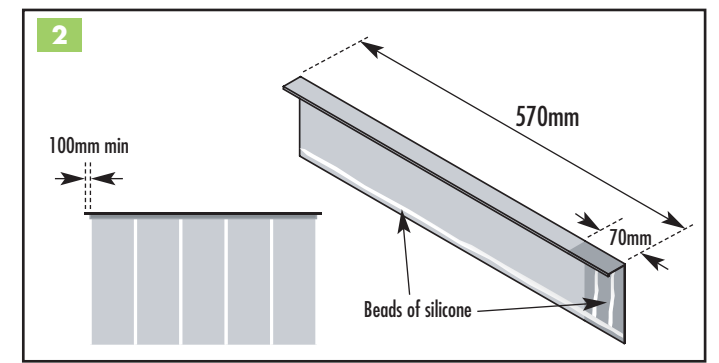

The horizontal flashing measures 570mm in length (500mm effective coverage, 70mm overlap). The flashing should extend beyond the wallplate capping by a minimum of 100mm each side.

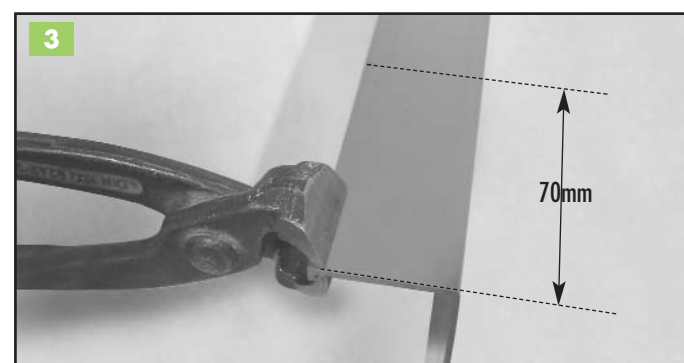

Before fitting the flashing, the "lip" on the upper leg of the trim requires removing to allow the flashing to sit flat and overlap 70mm onto the next flashing (see above).



Once positioned remove and apply 2 beads of silicone (clear or grey low modulus neutral cure) within the 70mm overlap area and along the lower leg, then re-insert. See sketch in step 2.



Continue along the roof.



Finally, seal each vertical at each end.